

TN019 – Sonnen eco 8 Battery Module Earthing Requirements

The battery modules contained within the sonnen eco8 series of products have different earth bonding requirement for the single phase and three phase systems due to differing inverter topology.

Sonnen eco 8.0 3Ph AC Coupled Sonnen eco 8.1 3Ph Hybrid

Both of the 3-Ph sonnen eco 8 systems utilise the same imbedded power electronics and therefore consist of the same inverter topology. The presence of galvanic isolation on the DC to DC converter between the battery modules and the main DC bus ensures that earth bonding of the battery modules is not required.

Note that within section 5.1 of the installation manual’s scope of delivery does not include the earth bonding cables.

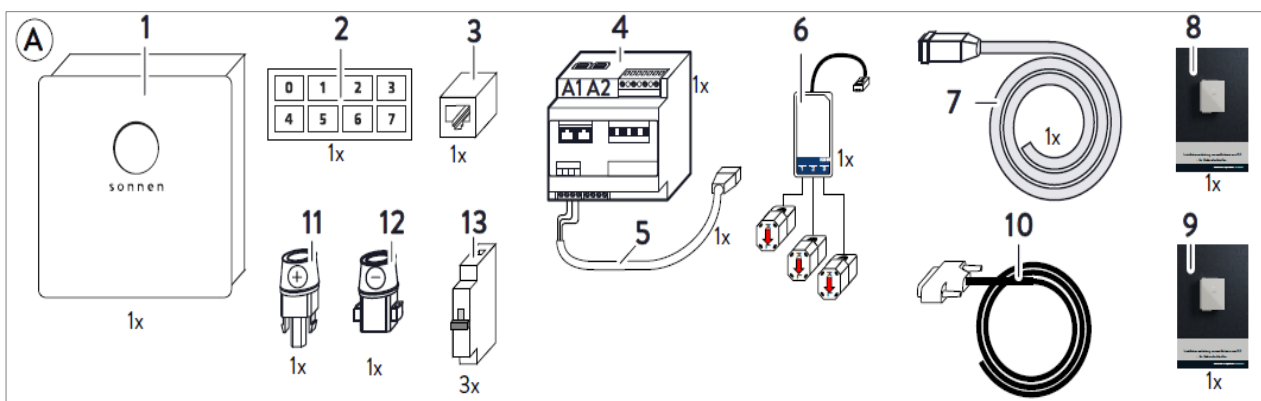

Sonnen eco 8.2 1Ph AC Coupled

The single phase sonnen eco 8.2 system does not offer galvanic isolation on the DC to DC converter between the battery modules and the main DC bus and therefore earth bonding of the battery modules is required.

Note that within section 5.1 of the installation manual, the scope of delivery includes the earth bonding cables (item 8).

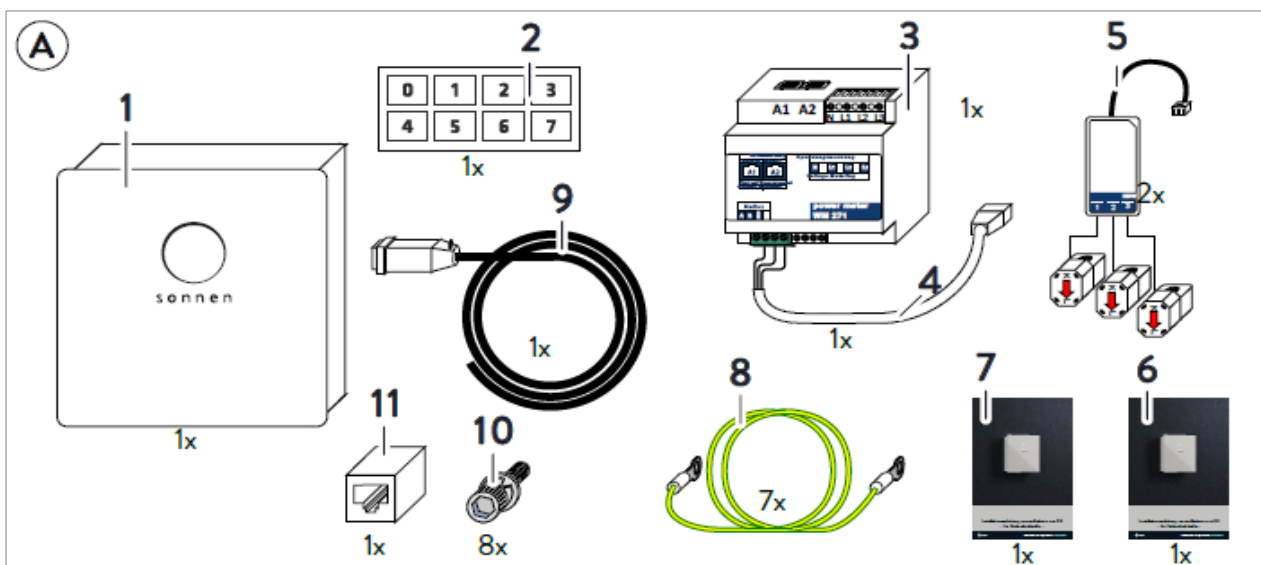

If you have any further questions or require support or assistance, please contact us at support@sonnen.com.au