



Sonnen eco 8.2

Z-Wave Control

sonnen eco 8

Z-Wave Control

The Z-Wave USB is supplied within the accessory kit of the main unit:

- » Insert the Z-Wave USB into the dedicated port of the PLC mounted on the rear of the main cabinet door.

Technical specifications:

- » Max standby power: 0.5W.
- » USB output: DC 5V±0.3V, 1000mA.
- » Operating temperature: 0 C to 40 C .
- » Relative humidity: 8% to 80%.
- » Operating distance: Up to 100 feet/30 metres indoors or 300 feet/100 metres outdoors.
- » AC Input: 230V 50Hz Max 10A
- » Operating Frequency: 921.42MHz

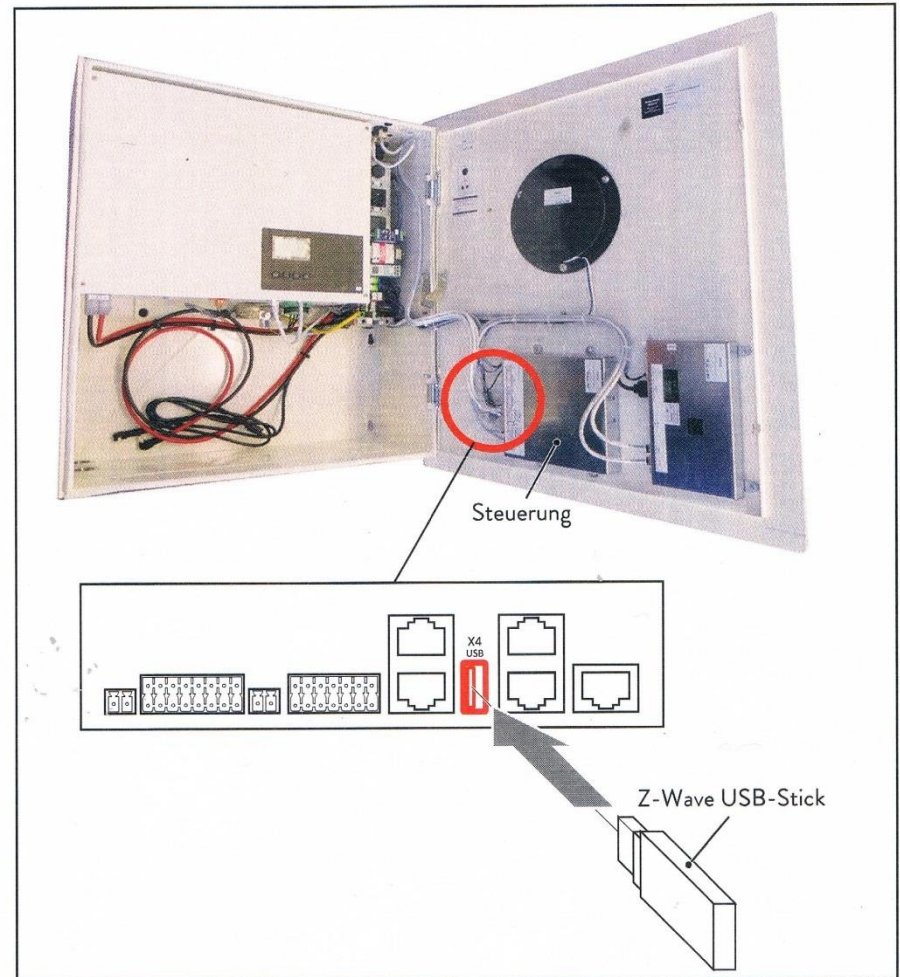

sonnen eco 8.2

Z-Wave Control

The Smart Switch 6 is a low-cost Z-Wave plug-in module specifically used to enable Z-Wave command and control (on/off) of any plug-in tool. It can report immediate wattage consumption or kWh energy usage over a period of time. In the event of power failure, non-volatile memory retains all programmed information relating to the unit's operating status.

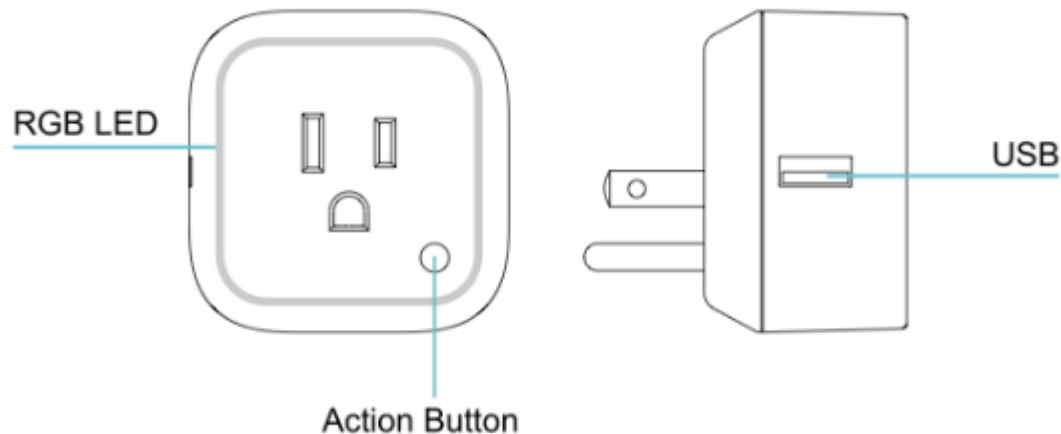

Its surface has Smart RGB LED, which can be used for indicating the output load status or strength of the wireless signal. You can configure its indication colour according to your preference.

Smart Switch 6 is also a security Z-wave device and supports Over The Air (OTA) feature for the product's firmware upgrade.

sonnen eco 8.2

Z-Wave Control

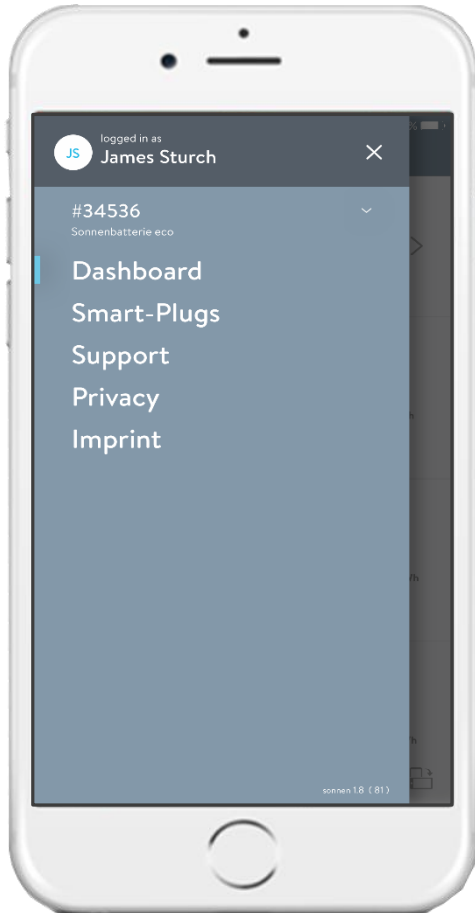

Once the USB has been inserted into the PLC, plug a Z-Wave Smart Switch 6 Socket into a wall outlet within 3 meters from the sonnen eco8.2 unit.

Via the Smartphone App select the 'Smart-Plugs' setting to proceed.



sonnen eco 8.2

Z-Wave Control

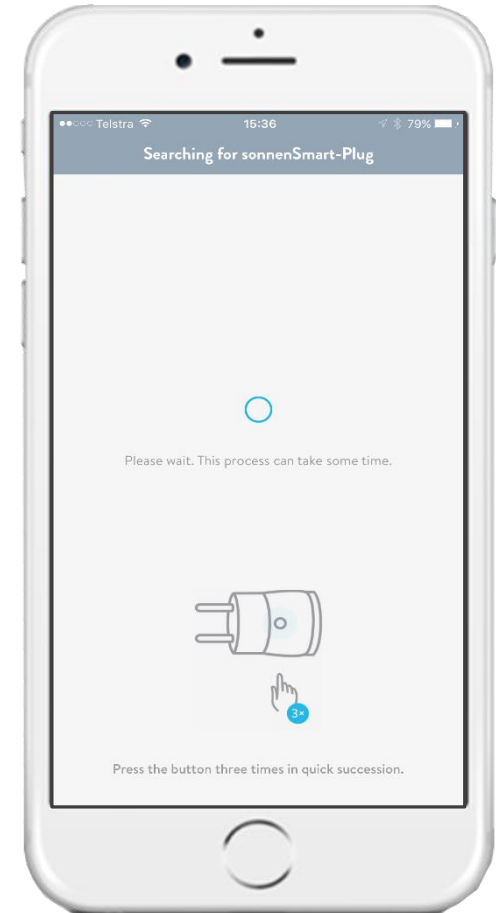
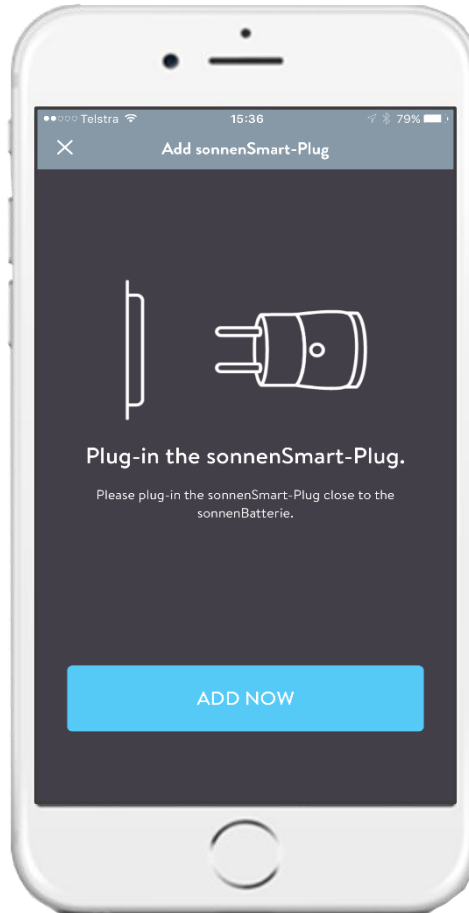
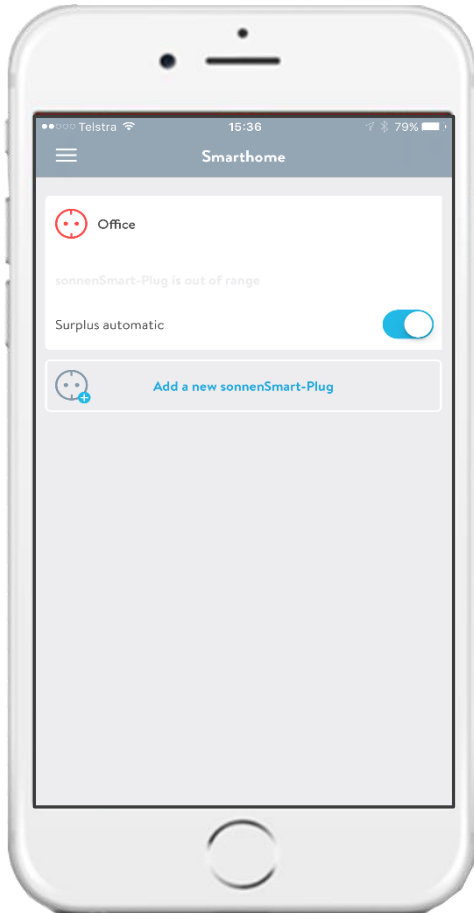

sonnen eco 8.2

Z-Wave Control

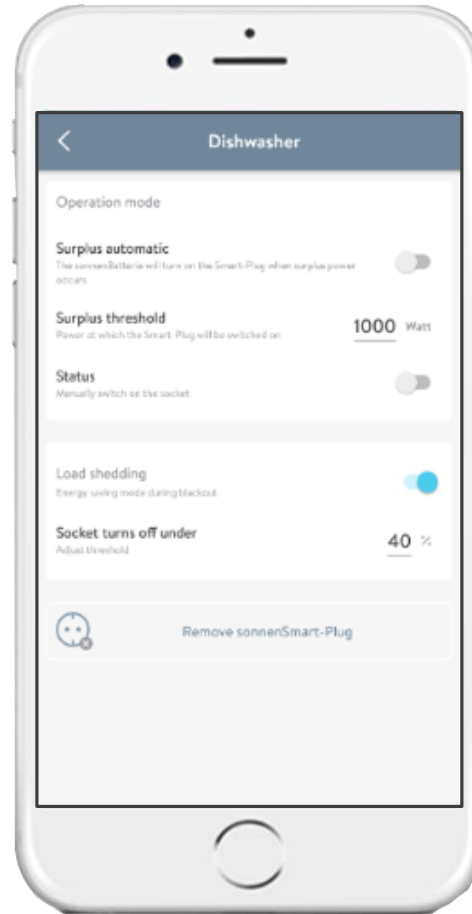
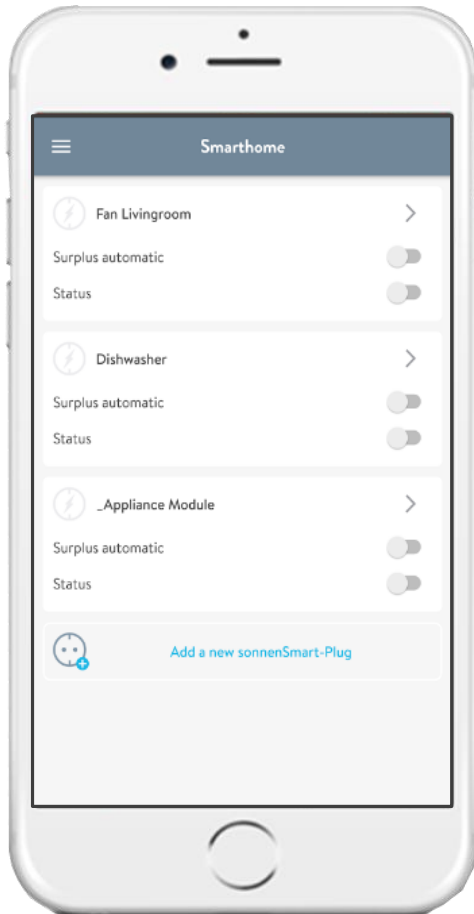

The device will then pair with the sonnen unit and you will be prompted to name the socket from a list of existing name or set your own.

You will then be able to set the surplus modes and auto or manual parameters.

sonnen eco 8.2

Z-Wave Control

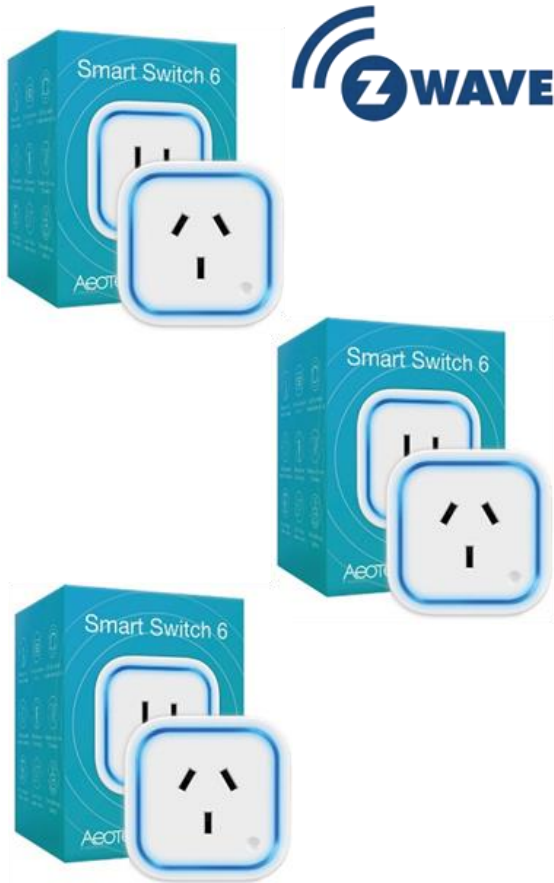

At some stage you may wish to reset all of your Smart Switch's settings to their factory defaults.

To do this, press and hold the Action Button for 20 seconds and then release it. Your Smart Switch will now be reset to its original settings, and the green LED will be solid for 2 seconds and then remain in gradient status as a confirmation.





sonnen